

Stronger together

Estonian Marine Initiative brings together eight companies who provide all the services passenger ship operators need to design, outfit and refurbish their vessels to the highest standard

Launched by Argo Sildvee in cooperation with design agency Velvet, the Estonian Marine initiative brings together eight key players from across Estonia's ship design, construction, outfitting and refurbishment supply chain. Together, the companies provide a one-stop-shop for shipowners who want to partner with a network of skilled professionals to outfit or refurbish their new cruise vessels and passenger ferries. "The initiative is supported by Enterprise Estonia, a national foundation that aims to develop Estonian economy."

"All eight companies are skilled and experienced, offer high-quality customer services and strive to complete every passenger ship project to the highest possible standard," says Sildvee. "They all have outstanding customer references and together, they can help ship operators in both Estonia and abroad to create unforgettable interiors for their vessels." **CFI**

Velvet

Velvet has a team of around 40 designers, producers, developers and researchers dedicated to providing high-quality consulting, architecture, engineering, graphic design and art direction, environmental design and wayfinding, and digital design and software development services to its clients, which include shipowners. The company takes responsibility for everything from the initial concept stages to the production-ready technical drawings and software development. Its success is built on its ability to take a strategic approach and collaborate with skilled partners.

DeRossi

Drawing on more than 20 years of experience, DeRossi's team of up to 250 specialists provides project design, engineering, production and installation services for shipowners and shipyards worldwide. The company also has its own furniture production line. Over the years, DeRossi has been a reliable partner for ship operators such as DFDS Seaways, Fjord Line and Hurtigruten, as well as shipyards like Fosen, Kleven and Brodosplit. Most recently, the company completed interior construction work on Hurtigruten's two new hybrid expedition ships, Roald Amundsen and Fridtjof Nansen.



Velvet

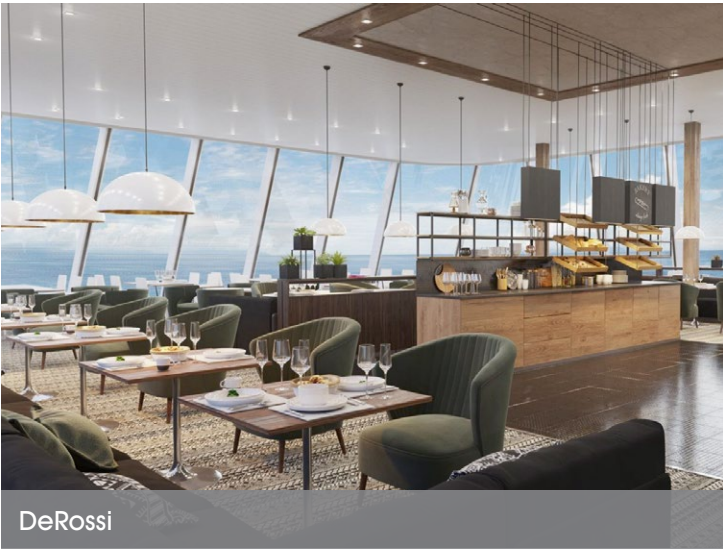

DeRossi



Divasoft



SRC Group



Insta Globe Engineering

Insta Globe Engineering

Staffed by more than 70 experienced professionals, Insta Globe Engineering installs and commissions various types of electrical and automation systems onboard all kinds of vessels. The company's fast and flexible team works globally, carrying out projects on cruise ships such as AIDA Cruises' AIDAprica and Hapag-Lloyd Cruises' Europa, as well as passenger ferries like Viking Line's Fstr and Scandlines' hybrid ferry Berlin.

SRC Group

Multinational company SRC Group provides design and engineering, technical and interior refit services for passenger ships and other marine projects. The company has offices in Estonia, Italy, Netherlands, Norway, South Korea and the USA, and can provide complex multidisciplinary services in any port or onboard ships while they are in service. Since 2000, SRC Group has completed over 4,000 projects worldwide, ranging from small repairs to turnkey retrofits. Notable projects include installing Burger King's first at-sea restaurant on Tallink Grupp's Star and refurbishing eateries and bars on its Silja Symphony and Silja Serenade ferries.

Divasoft

Family-owned company Divasoft has been producing upholstered furniture with high-quality plywood and solid wood frames since 1995. To ensure it fulfils its mission of providing customers with great sofas for a great price, Divasoft complies with International ISO 9001 quality management and 14001 Environment Management System standards. The company's ability to create custom furniture and undertake projects of any size makes it the perfect partner for shipowners who want to provide guests with comfortable and durable seating.



Eumar Design



Plaat Detail



Marmi Futerno

Eumar Design

Eumar Design manufactures and supplies luxury creacore and gelceramic composite stone bathrooms for cruise ships. Its GelCeramic Lightweight composite stone material reduces the weight of bathroom products by up to 50 per cent, helping shipowners to significantly reduce costs, fuel consumption and their environmental impact in the long term. The company has also developed 100% Antimicrobial, the world's first component for composite stone products that has been clinically proven to kill 95 per cent of bacteria within two hours of exposure and 99.9 per cent within 24 hours.

Plaat Detail

Established in 1996, Plaat Detail manufactures and distributes high-pressure laminate products for furniture producers, interior designers and construction companies. The company's products, which can be installed onboard passenger ships and custom-designed to meet a customer's specific requirements, include laminated boards, windowsills, worktops, furniture doors, shelf elements, wall panels and more. Plaat Detail is also an official distributor of Alucoil, Corian, Döllken, Fipro, Formica, Garnica, Homapal, Pfleiderer, Unilin and Vivix distributor in the Baltics.

Marmi Futerno

Marmi Futerno delivers custom-made stone products for restaurants, shops and residential interiors. Projects are mostly accomplished in cooperation with interior architects and furniture manufacturers. The company has a modern factory equipped with a full range of machinery for processing all kinds of marble, granite, quartz and ceramic materials. Over the past 18 months, Marmi Futerno has become a firm favourite with multiple companies working in the ship construction industry.